

DOLING PARK PROJECT

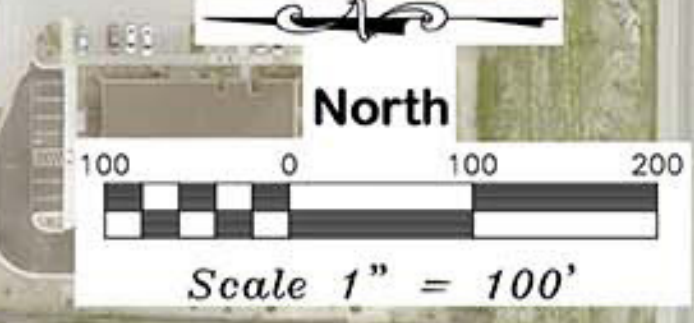

LEGEND

- EXISTING EASEMENT
- LOT LINE
- PROPERTY LINE
- RIGHT-OF-WAY LINE
- SECTION LINE
- SUBDIVISION LINE
- EXISTING SANITARY SEWER LINE
- PROPOSED SANITARY SEWER LINE
- PROPOSED EASEMENT/CONSTRUCTION CORRIDOR LIMITS
- PROPOSED PERMANENT EASEMENT
- PROPOSED TEMPORARY EASEMENT
- PROPOSED PERMANENT INGRESS/EGRESS EASEMENT
- PROPOSED TEMPORARY INGRESS/EGRESS EASEMENT
- PROPOSED TEMPORARY CONSTRUCTION/ACCESS CORRIDOR
- ① ABSTRACT NUMBER

Property Owner List

Abstract No.	Parcel ID No.	Owner	Parcel Book/Page	Property Address	Permanent Sanitary Sewer Easement		Temporary Construction Easement/Corridor		Ingress/Egress Easement	
					Area (sq. ft.)	Book/Page	Area (sq. ft.)	Book/Page	Area (sq. ft.)	Book/Page
1	1302119007	MARANATHA VILLAGE INC	Bk 2015, Pg 041991-15	304 W BETHANY DR	5,503		14,635		0	
2	1302119037	GOOD NEWS KANSAS CHURCH	Bk 2019, Pg 006299-19	3000 3330 N GRANT AVE	36,577		55,490		0	
3	1301204082	GOOD NEWS KANSAS CHURCH	Bk 2019, Pg 006299-19	E NORTON RD	36,577 (combined w/2)		55,490 (combined w/2)		3,020	
4	1301204074	MARANATHA VILLAGE INC	Bk 2015, Pg 041991-15	233 E NORTON RD	0		0		6,042	
5	1301206040	WHEELER TRACY ETAL	Bk 2504, Pg 0801	W NORTON RD	1,681		5,256		0	
6	1301206041	THE CITY OF SPRINGFIELD	Bk 2279, Pg 0778	S CAMPBELL AVE	3,721		16,696		0	
7	1301207048	WANT MORE PROPERTY LLC	Bk 2017, Pg 044001-17	2860 N CAMPBELL AVE	6,902		15,298		10,839	
8	1301207072	MARSEY VIRGINAT	Bk 2017, Pg 022624-17	2856 N CAMPBELL AVE	0		0		0	
9	1301207068	HS INVESTMENTS LLC	Bk 2016, Pg 028410-16	N CAMPBELL AVE	14		549		0	
10	1301207024	THE CITY OF SPRINGFIELD	Bk 2971, Pg 2280	N CAMPBELL AVE	17,008		38,861		0	
11	1301301003	PUBLIC PARK BOARD	Bk 652, Pg 60	301 E TALMAGE ST	31,053		178,023		0	
12	1301301019	C&A STORAGE CORP ETAL	Bk 2009, Pg 039633-09	2003 N BENTON AVE	22,940		81,930		0	
13	1301301004	THE CITY OF SPRINGFIELD	Bk 681, Pg 263	E TALMAGE ST	2,823		4,354		0	
14	1301207007	THE CITY OF SPRINGFIELD	Bk 2005, Pg 071808-05	324 E EVERGREEN ST	0		39,359		0	
15	1301207005	WASHAM CHRISTOPHER R ETAL	Bk 2017, Pg 036524-17	404 E EVERGREEN ST	0		0		0	

PROPERTY AGREEMENT NOTES

(NO RECORD PROVIDED OR DISCOVERED FOR RIGHT OF WAY OF TALMAGE STREET AND CAMPBELL AVENUE IN THE NW1/4 SW1/4)

Right-of-Way Plan - South

AM
ALLGEIER, MARTIN and ASSOCIATES, INC.
Consulting Engineers
7231 East 24th Street | Joplin, Missouri 64804
417.880.7200 | Fax 417.880.7300 | www.amco.com
Missouri State Certificate of Authority No. 000427

DEPARTMENT OF ENVIRONMENTAL SERVICES
SPRINGFIELD, MISSOURI

DOLING PARK
SANITARY SEWER CAPACITY IMPROVEMENTS
CITY PLAN NO. 2020PW0044

APPROVED BY _____ DATE _____
DIRECTOR OF PUBLIC WORKS

SURVEY BY GREAT RIVER ENG.	DESIGN ALLGEIER, MARTIN	SCALES	SHEET 5
FIELD BK	DRAWN TEH	HOR. NA	OF SHEETS
LEVEL BK	CHECKED RDM	VERT. NA	FILE NO. 2020PW0044

RIGHT-OF-WAY PLAN 1
SCALE: HOR: 1" = 100'

AMA PROJECT NO. SPR17020004